

T.N.H.B. LAND

EXISTING TENEMENTAL BLOCK

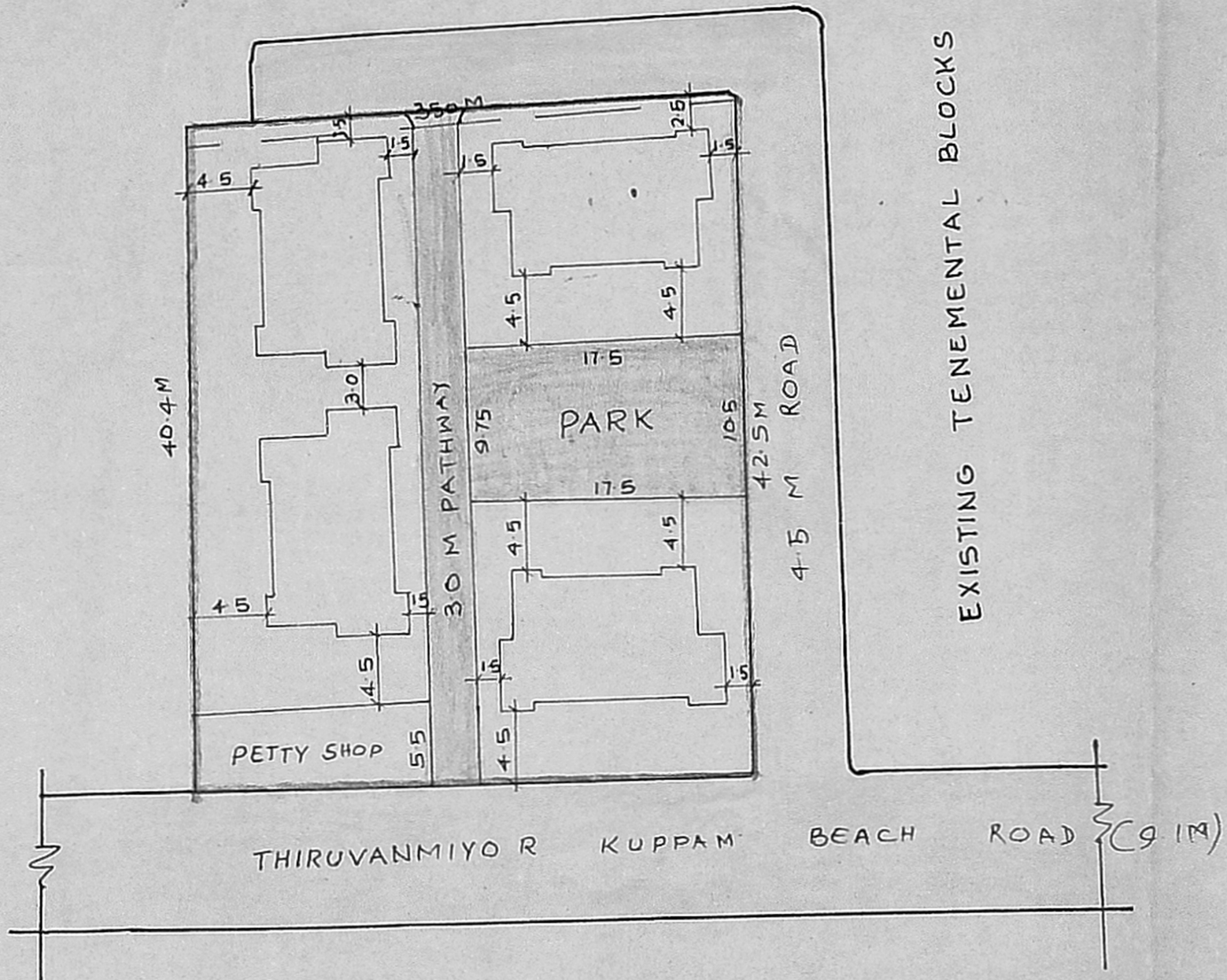

TOTAL EXTENT (0.15 HEC) : 1500 M<sup>2</sup>  
 NO. OF TENEMENTS : 48.

(Office copy)

P.P.D No. 64-A  
 L.O (P) No. 92

APPROVED 18/7/92  
 VIDE LETTER NO:- L2/7650/92  
 DATED:- 6-92

*Handwritten signatures and initials:*  
 12/3/8  
 SP  
 18/7/92

FOR MEMBER SECRETARY  
 MADRAS METROPOLITAN  
 DEVELOPMENT AUTHORITY.

M.R. Radan (TRAINEE)  
 TRACED BY:

PA A.P D.P.

TAMILNADU SLUM CLEARANCE BOARD.

LAYOUT FOR CONSTRUCTION OF TENEMENTS AT RAJIVGANDHI NAGAR  
 IN THIRUVANMIYUR VILLAGE. PHASE - II

SCALE: 1" = 33 FEET (1:400)





